



CONFERENCE FLOOR PLANS AND CAPACITIES



The Maslow

SANDTON

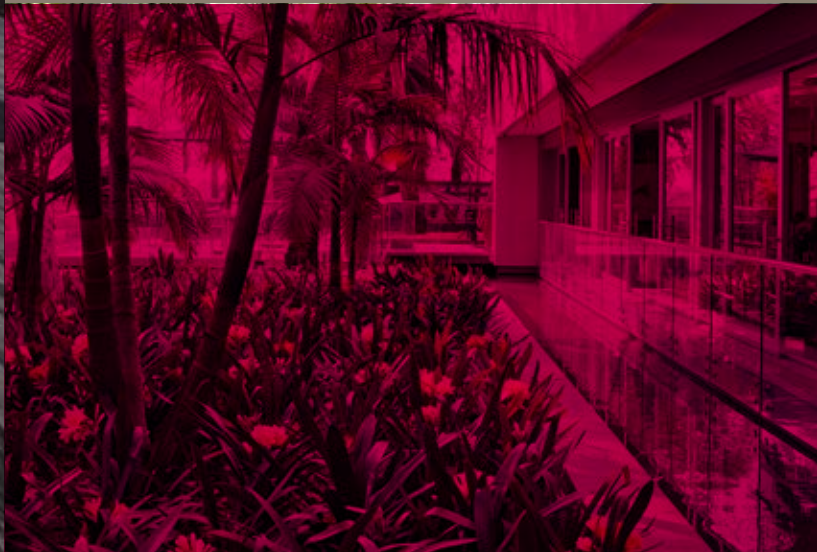



WHERE DREAMS COME ALIVE

Sun International prides itself on being Africa's premium tourism, leisure and gaming group. For over 30 years, our wide range of resorts, luxury hotels and casinos have set the benchmark across South Africa and beyond, with each property offering guests a world of exhilarating experiences.

Creating lasting memories for guests is a core part of the brand. From soaking up some sun to fine dining, gripping game-plays and convenient conferencing, Sun International has the best services and facilities to turn each guest's desires into a memorable reality.

MEETING ROOMS

At The Maslow, every meeting room is designed to be a game changer – a place that fosters success. Ranging from 24m² to 56m² they are conducive to productive workshops, strategic thinking and effective team building. The meeting rooms offer a maximum seating capacity of 20 guests as well as natural lighting. There is a dedicated lunch area which seats 34 guests and a lobby area leading onto oasis gardens that offer alternative breakaway zones for meeting and dining opportunities.

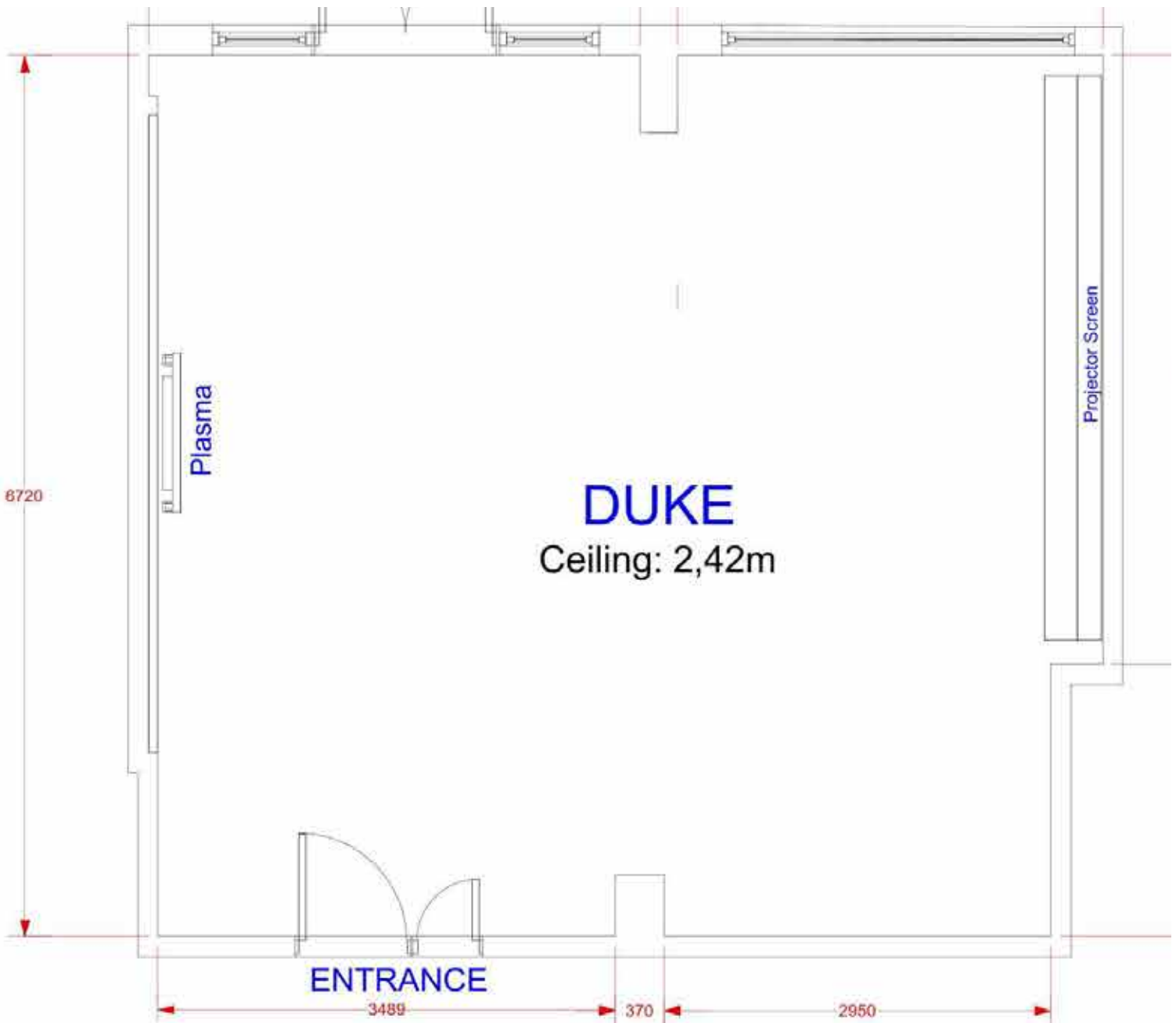

MEETING ROOM SPECIFICATIONS



MEETING ROOM SPECIFICATIONS

VENUE		LENGTH	WIDTH	SQM	HEIGHT	MEETING	U SHAPE	VENUE HIRE
Edison	6	6	4	24	2.41	12	-	R2 500
Tata Room	4	7	5	35	2.41	8	-	R3 000
Carnegie Room	5	8	5	40	2.41	8	-	R3 500
Hinde Room	7	8	7	56	2.41	8	-	R3 500
Vanderbilt Room	8	8	7	56	2.41	12	-	R3 500
Duke Room	9	8	7	56	2.41	-	20	R3 500
Seligman Room	10	8	4	32	2.8	12	-	R3 000
Morgan Room	11	8	4	32	2.8	-	20	R3 500
Walton Room	12	8	4	32	2.8	12	-	R3 000
Stanford Room	13	8	5	40	2.41	-	20	R3 500



SOCIAL DISTANCING CAPACITIES

VENUE	LENGTH	WIDTH	SQM	HEIGHT	Boardroom	U-SHAPE	VENUE HIRE
Tata Room	7	5	35	2.41	6	-	R2 500
Carnegie Room	8	5	40	2.41	8	-	R3 000
Hinde Room	8	7	56	2.41	10	-	R3 500
Vanderbilt Room	8	7	56	2.41	10	-	R3 500
Duke Room	8	7	56	2.41	-	8	R3 000
Seligman Room	8	4	32	2.8	8	-	R3 000
Morgan Room	8	4	32	2.8	-	8	R3 000
Walton Room	8	4	32	2.8	8	-	R3 000
Stanford Room	8	5	40	2.41	-	7	R3 000

CONFERENCE CENTRE

The Maslow Conferencing Centre offers an inspiring location to do business in Sandton and offers spacious facilities. A selection of carefully selected menus are available to suit your needs.

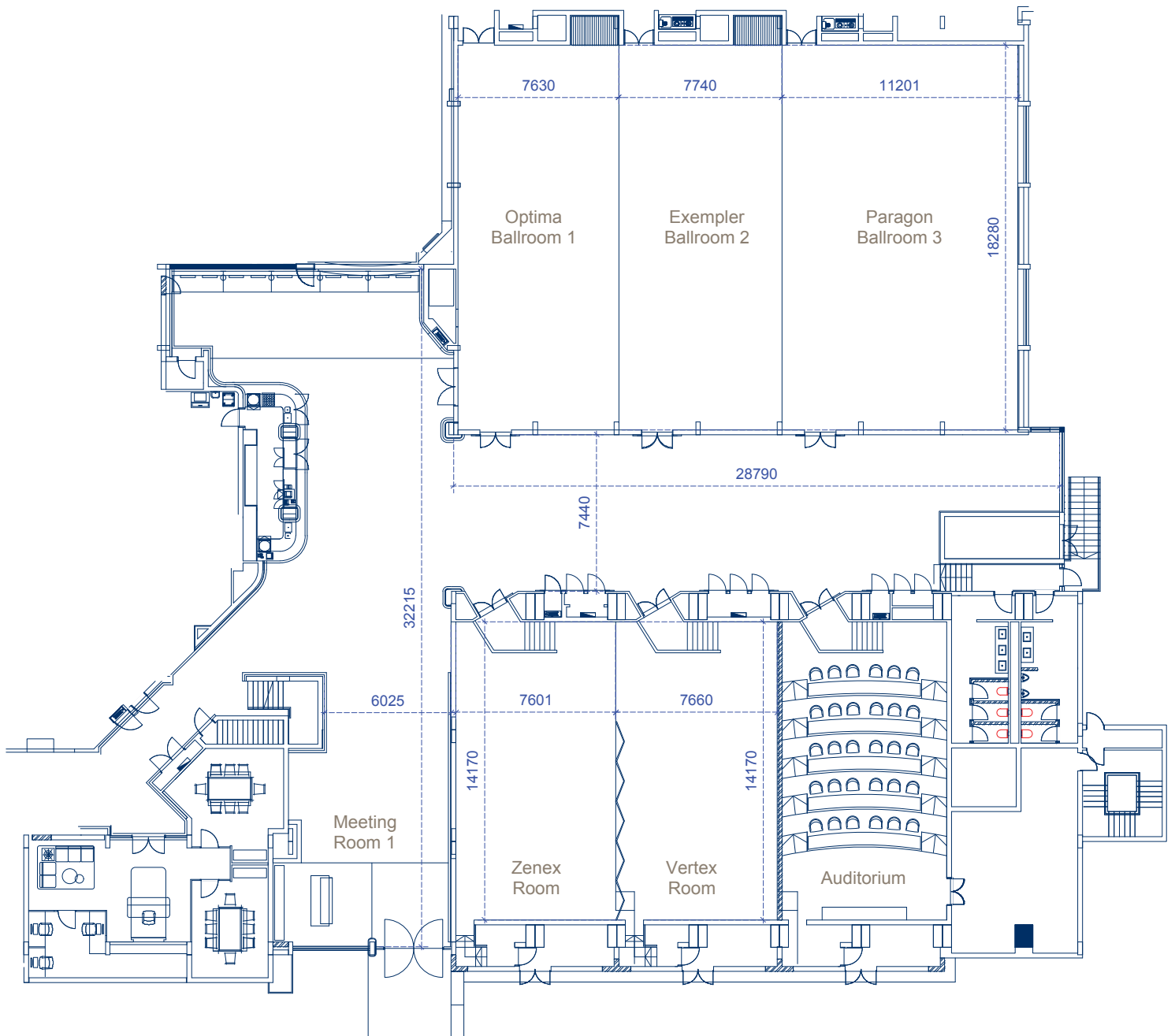

The Full Ballroom

Our full ballroom is the largest venue accommodating a maximum of 420 delegates. It is a divisible ballroom which can be divided into 3 partitions and is popularly used as the plenary venue. It is also largely used for gala dinners and wedding receptions.



Paragon (Ballroom 3)

This venue is also known as ballroom 3 as it forms part of the full ballroom, as the third partition. Paragon is the largest of the three and is the only venue with natural lighting in the conference centre.



Auditorium

This venue is a 50 seater auditorium which provide each guest with their own charging plug points. It is popular for press conferences, media briefings and as a breakaway venue as well.



AUDITORIUM



Zenith and Vertex

These two venues can be merged into one venue and can also be separated as two different venue through a partition. These venues are popularly use for smaller conferences, presentations, exhibition as well as breakaway rooms.



Pre Assembly

This area is the lobby area outside the conference venues and is used for the tea break as well as lunch. This space features a bar and is also available for networking or cocktail events.



Business Centre:

These small boardroom are popularly used as an office and storage space by the conference organizing team or a space to hold private meetings.



Garden

The Maslow features an oasis garden suitable for hosting various events such as wedding ceremonies, picnics, birthday lunches, bridal showers and is also used as a conferencing lunch and networking venue for up to 200 guests.

